

# Pan-Tilt-Unit PT5 Settings MxCC and MxMC

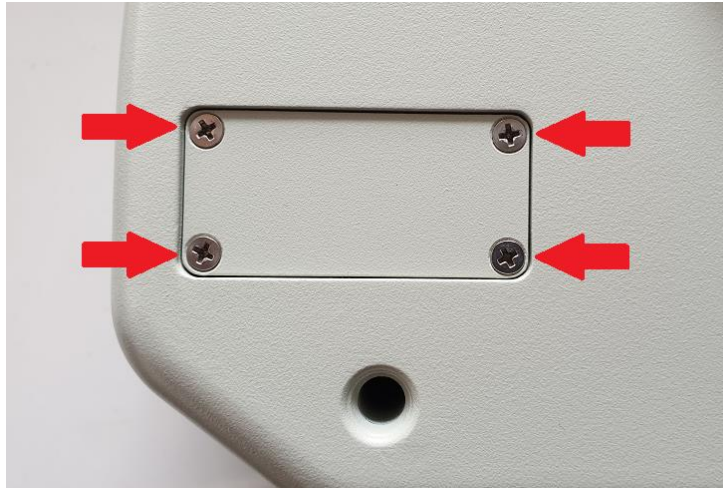

## MxCC

(„PT4-Setting“)

**Supported Cameras:**  
All MX-Cameras with USB  
(every Firmware)

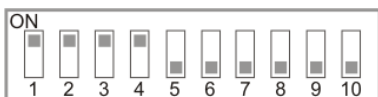

## MxMC

(Version 2.1.1 and above)

(and MxCC (Pelco-D Setting))

**Supported Cameras:**  
Mx6 (Firmware V5.2.4.15 and higher)  
Mx5 (Firmware V4.7.2.34 and higher)

